

Ancon[®]
Suspended Brickwork
Four ways to create attractive
soffit details



We are one team. **We are Leviat.**

Leviat is the new name of CRH's construction accessories companies worldwide.

Under the Leviat brand, we have united the expertise, skills and resources of Ancon and its sister companies to create a world leader in fixing, connecting and anchoring technology.

The products you know and trust will remain an integral part of Leviat's comprehensive brand and product portfolio. As Leviat, we can offer you an extended range of specialist products and services, greater technical expertise, a larger and more agile supply chain and better, faster innovation.

By bringing together CRH's construction accessories family as one global organisation, we are better equipped to meet the needs of our customers, and the demands of construction projects, of any scale, anywhere in the world.

This is an exciting change. Join us on our journey.

Read more about Leviat at [Leviat.com](https://www.leviat.com)



Our product brands include:

Ancon

HALFEN

HELIFIX 

 **ISEDIO**

PLAKA



60

locations

sales in
30+

locations

3000

people worldwide

Imagine. Model. Make.

Leviat.com

Suspended Brickwork

Four ways to create attractive soffit details

Deep reveals and soffits are an increasingly popular design feature that add an extra depth and dimension to masonry façades. Creating these effects can be key to the aesthetics of the building but can pose engineering problems as the main building façade must be maintained across an opening, while seeming to be unsupported by structural steelwork.

The unique expertise of Leviat in the design and manufacture of high integrity steel components has enabled the company to develop four effective solutions to achieve this popular design feature – allowing architects greater freedom in design.

Solutions range from the suspension of factory-made brick faced steel or precast concrete units that are simply lifted and bolted to the underside of an Ancon MDC brick support system, to more complex hanger systems that are assembled on site using Ancon stirrups and stitching rods or channels and dowelled wall ties.

All systems are manufactured to meet individual project specifications. System designs vary depending on factors such as load, cavity, soffit dimensions, brick pattern and coursing.

Our experience shows a prefabricated soffit offers contractors a far easier and more cost-effective solution. Nexus®, has been developed in partnership with cut-brick specialist Ibstock Kevington and offers a lightweight steel alternative to cast concrete. The latest innovation, Nexus® XI, is a mechanically fixed brick-faced support system and lintel range which further enhances the already popular Nexus® offering. See pages 4-5 for more information.

Contents

Nexus® Brick Faced Support System	4-5
Precast Concrete System	5
Hanger Tie System	6
Stirrup and Stitching Rod System	7

Brick Slip Systems

Ideal for large/numerous soffits

- Nexus® lightweight steel system – bolted to MDC brick support
- Precast concrete system – bolted to MDC brick support

Full Brick Systems

Ideal for the occasional/small opening

- Hanger tie system – channel on underside of MDC brick support to carry hanger ties
- Stirrup and stitching rod system – attached to MDC brick support

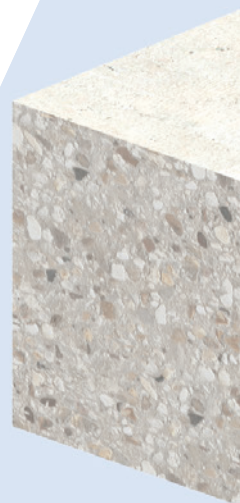

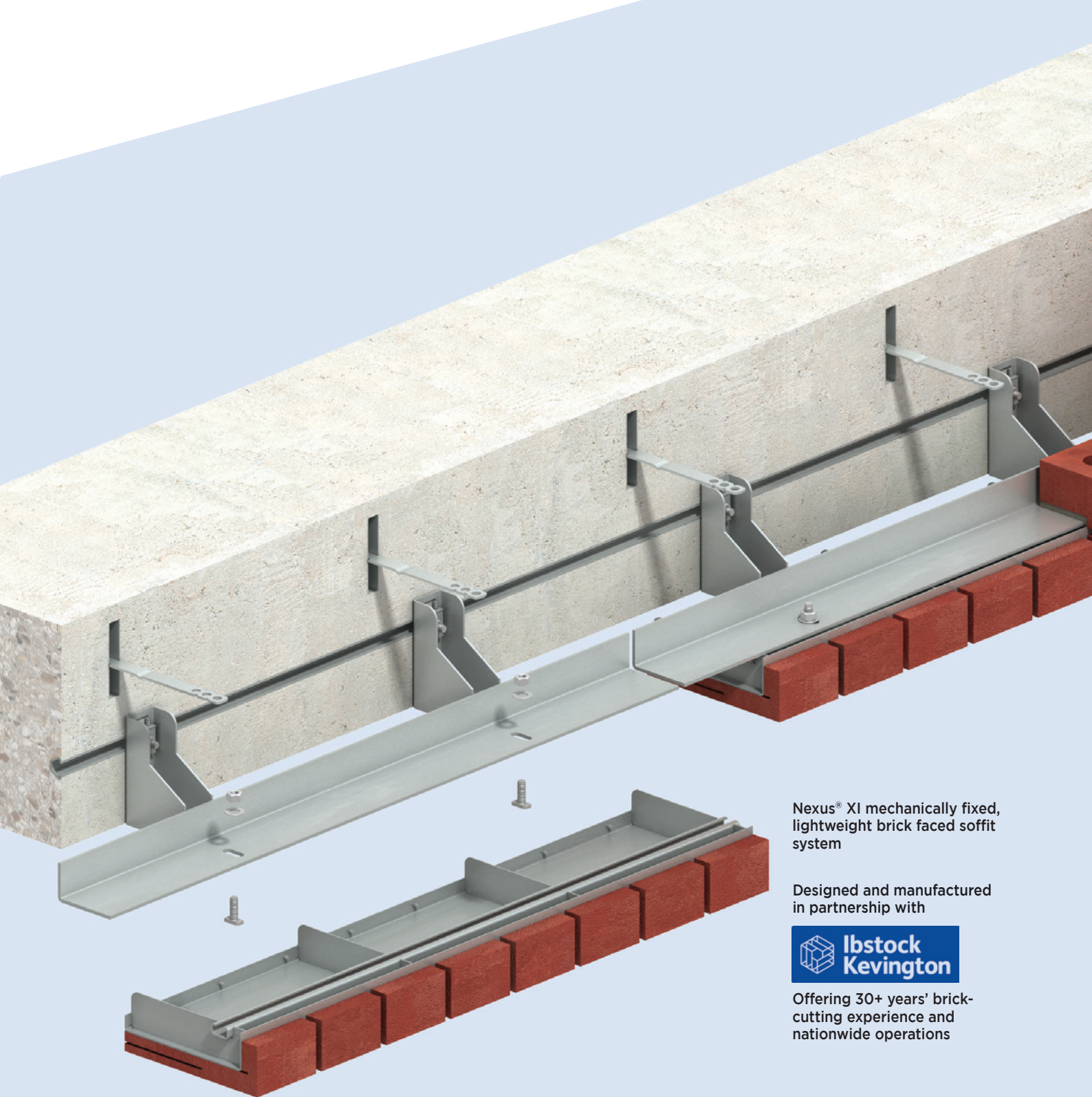

Nexus® XI mechanically fixed, lightweight brick faced soffit system

Designed and manufactured in partnership with



Offering 30+ years' brick-cutting experience and nationwide operations



Brick Support Specialist



Free Technical Advice and Design Service



Bespoke Solutions



Manufactured in the UK



ISO 9001, ISO 14001 and OHSAS 18001



100% Corrosion Resistant Stainless Steel



Hidden Support - No Exposed Steelwork



Animated Installation Video



UKCA & CE Marked to BS EN 1090-1

Suspended Brickwork

NEXUS® Next Generation Brick Faced Support System

- ✓ Lightweight, prefabricated system
- ✓ Developed by two industry experts
- ✓ Two-part system allows full adjustment for perfect alignment
- ✓ Easier to handle than precast concrete systems
- ✓ Quick to install - no mechanical lifting

NEW NEXUS® XI

- ✓ 'A' Fire Rating
- ✓ Suitable for buildings over 18m
- ✓ Complies with Building Regulations Approved Document B: Fire Safety 2019
- ✓ Brick slips mechanically fixed to stainless steel soffit unit

Ancon MDC support system with mechanically fixed Nexus® XI brick faced soffit unit from Ibstock Kevington

RECOMMENDED SOLUTION

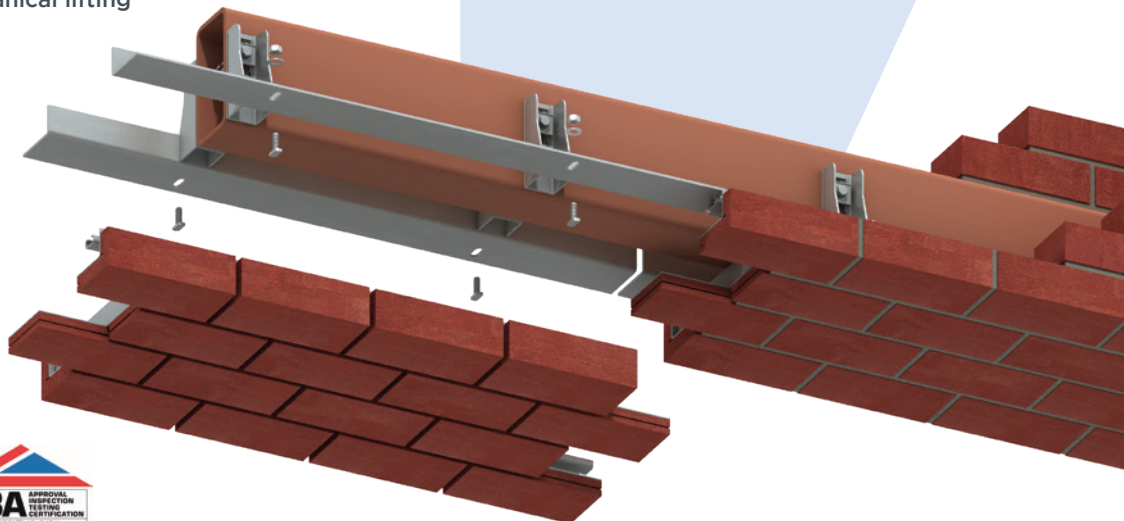

Nexus® combines a lightweight, steel-backed, brick faced unit manufactured by Ibstock Kevington with our tried and tested Ancon MDC stainless steel bracket angle support system.

The system offers considerable benefits over cast concrete alternatives (page 5). It cuts the weight by more than half, which in most cases will allow the brick faced units to be installed without specialist lifting equipment and provides significant savings in installation time, making it particularly appropriate for fast-track or time-limited projects.

Individual Nexus® units are designed and prefabricated off-site to suit the soffit dimensions so there is no cutting required on-site. They are simply offered up to the pre-fixed and pre-drilled Ancon MDC angle and then bolted into position using T-head fixings in a continuous channel.

The two-part design allows maximum adjustability, both vertically and horizontally, for quick and simple alignment on site.

Being the first brick-faced soffit unit recognised by the BBA to offer a working life commensurate with the building on which it is installed, Nexus® should now be specified with even greater confidence than ever before.

NEXUS® XI, the latest addition to the NEXUS® family, provides an innovative mechanically fixed suspended brickwork soffit and lintel solution. NEXUS® XI has secured an 'A' fire safety rating from the BBA, meaning it can be specified and installed with confidence on high-rise residential buildings over 18 metres, in compliance with the recent amendment to Approved Document B of the Building Regulations.

For more detailed product information please refer to the Nexus® brochure.

SIMPLE INSTALLATION

1. Install Ancon MDC Nexus® support system ensuring fixing bolts are fully torqued.
2. Fix Nexus® brick faced unit to pre-installed support system by finger tightening bolts.
3. Adjust vertical and horizontal alignment. Fully tighten bolts to correct torque.
4. Point to match main brickwork.



Scan the code to watch an installation video.

A full installation guide is available to download from www.ancon.co.uk

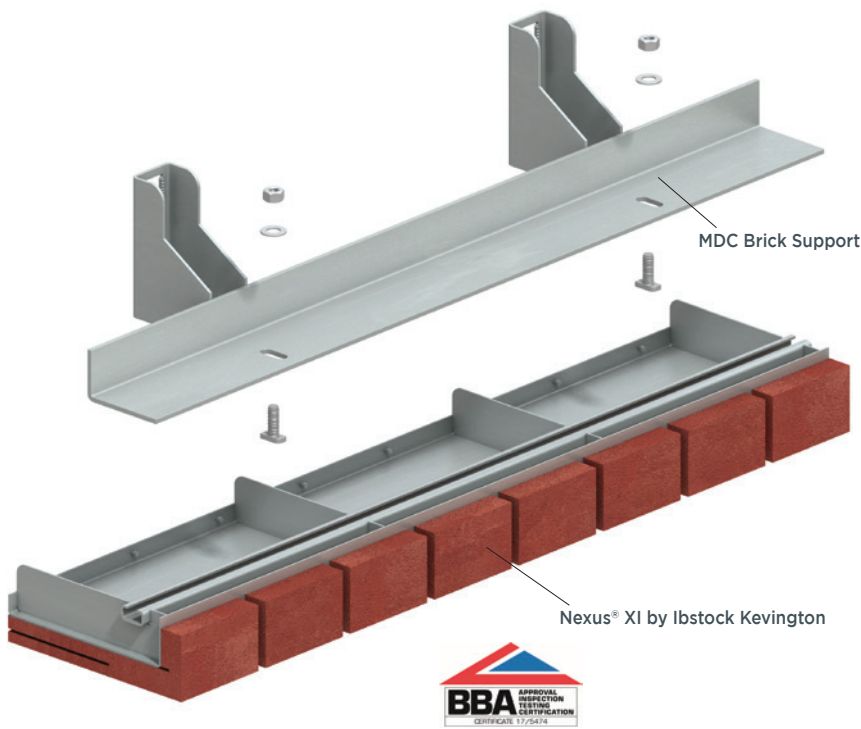

Nexus® in use at Silchester, Kensington and Chelsea Redevelopment

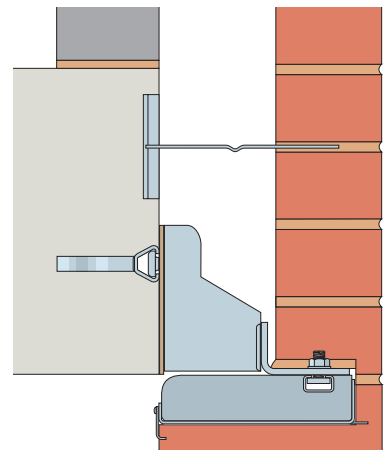

MDC Nexus® XI Support System

Precast Concrete System

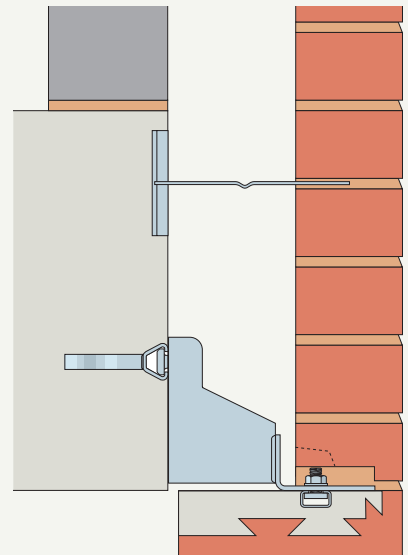
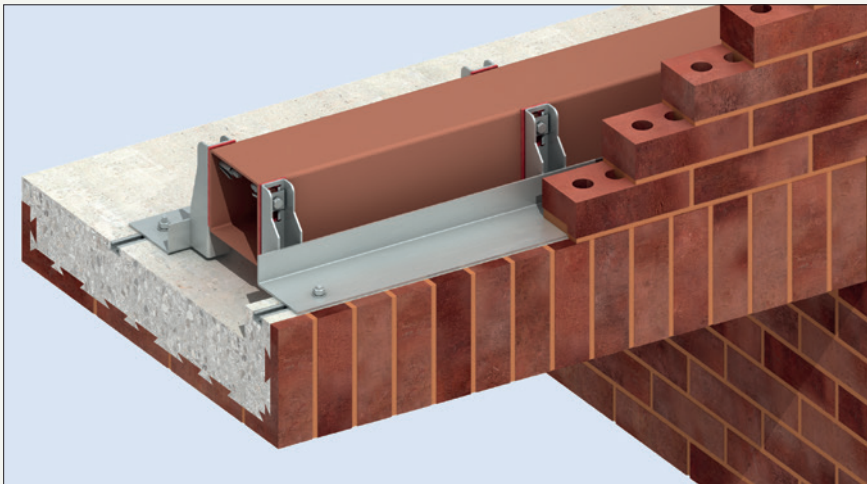

MDC with Precast Masonry Unit

Ancon MDC systems can be designed and manufactured to suspend precast, prefabricated masonry units (supplied by others). Like Nexus, this system removes the build of complicated, time-consuming masonry soffits from a tight site schedule. Unlike Nexus, however, these offsite-manufactured units require a mechanical lifting device when bolting to the underside of an Ancon MDC angle.

HOW IS THIS SYSTEM INSTALLED?

Install Ancon MDC support system ensuring fixing bolts are fully torqued. Lift and support the precast masonry unit and fix to pre-installed masonry support system by finger tightening bolts. A mechanical lifting device will be required. Adjust vertical and horizontal alignment. Fully tighten bolts to correct torque. Point to match main brickwork.

Contact us with your project requirements

Suspended Brickwork

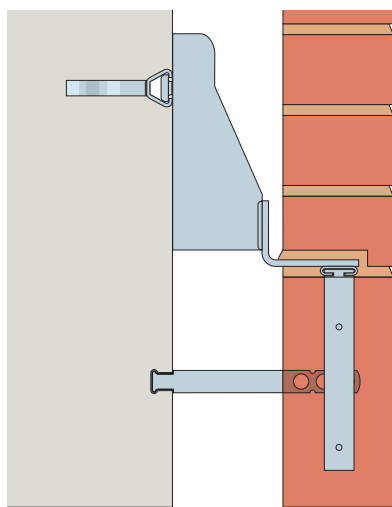
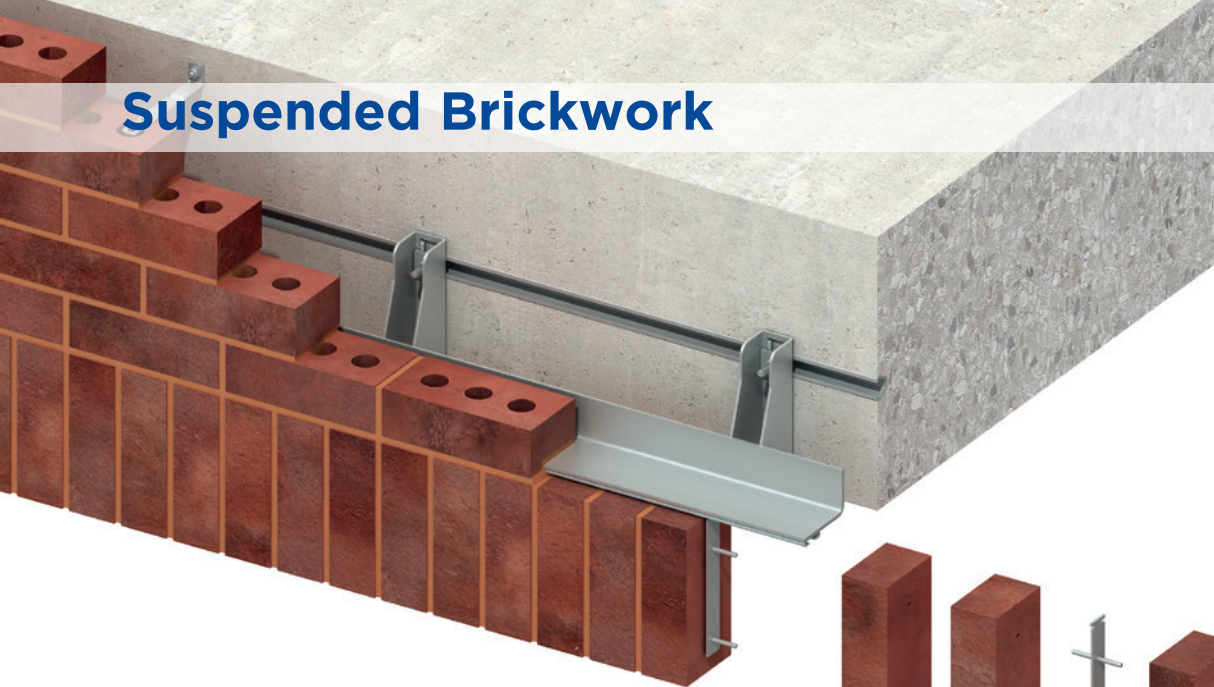

MDC with Channel and Hanger Tie

Hanger Tie System

- ✓ Ideal for solid bricks
- ✓ Suitable for small, simple openings
- ✓ Assembled on site

A brickwork soffit without visible means of support can be created when suspending a soldier course of brickwork using a stainless steel hanger system. The Ancon system comprises wall ties complete with welded dowels that fix to Ancon 36/8 channel welded to the underside of the Ancon MDC masonry support angle. The soldier course is constructed by positioning pre-drilled bricks onto the dowelled hanger ties.

HOW IS THIS SYSTEM INSTALLED?

Install Ancon MDC support system ensuring fixing bolts are fully torqued. Brickwork is built up to support angle level on each side of the opening. A temporary support is built for the soffit bricks.

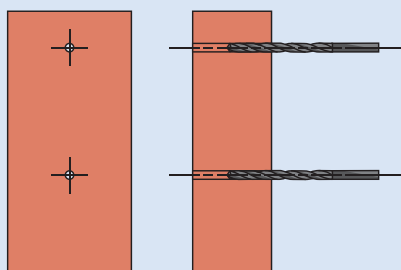

7mm diameter holes are drilled through each soffit brick at the dowel positions. Position first brick on the temporary support.

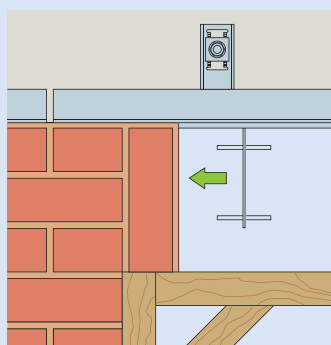

Insert dowelled hanger tie into channel by turning head through 90° and slide towards brick. Press into and cover with mortar.

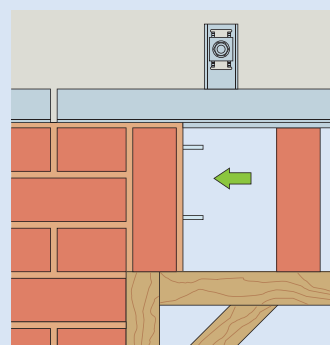

Push next brick onto hanger tie. Cover side of brick with fresh mortar and position next brick.

Repeat until all bricks are installed. Ensure that the vertical joints are fully filled with type M12 (or equivalent) mortar. Brickwork is pointed. Temporary support is removed. A full installation guide is available to download from www.ancon.co.uk.

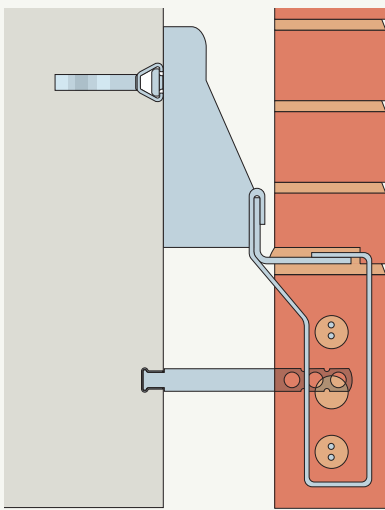
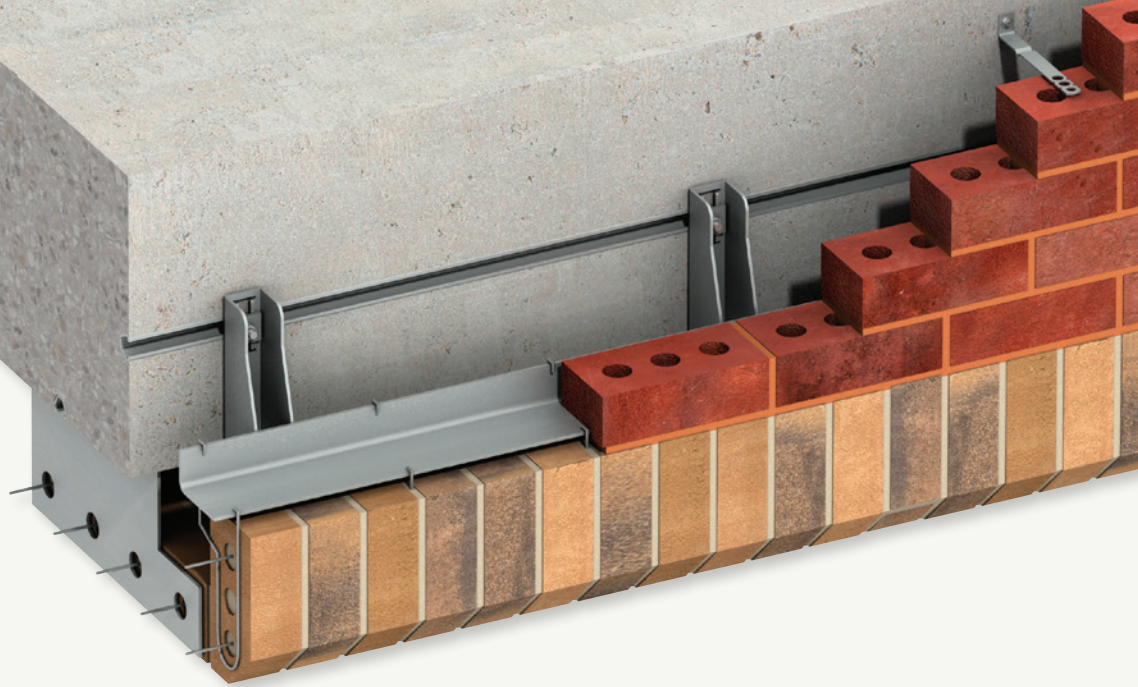

MDC with Stirrup and Stitching Rod

Stirrup & Stitching Rod System

- ✓ Ideal for cored bricks
- ✓ Suitable for small, simple openings
- ✓ Assembled on site
- ✓ Suitable for the skilled tradesman

A brickwork soffit without visible means of support can be created by suspending a soldier course of brickwork on stainless steel stirrups located at 225mm centres. The stirrups fit over the angle and stitching rods span between the stirrups, supporting cored or holed bricks.

HOW IS THIS SYSTEM INSTALLED?

Install Ancon MDC support system ensuring fixing bolts are fully torqued. Brickwork is built up to support angle level on each side of the opening. A temporary support is built for the soffit bricks.

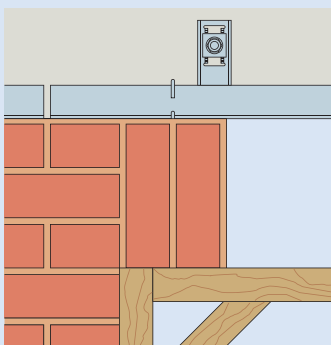

Clip stirrup onto support angle upstand. Offer a brick either side of the stirrup, filling the joint and brick cores completely with mortar.

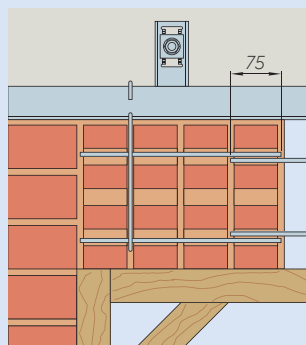

Position another two bricks, filling joints and cores with mortar. Stitching rods are fed through the brick cores with a 75mm overlap.

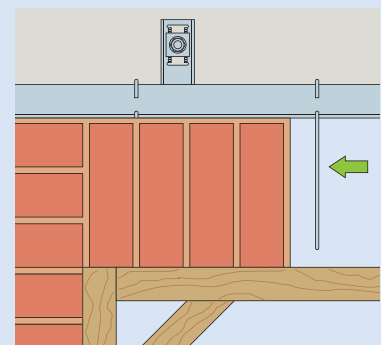

Clip next stirrup onto support angle and repeat with stirrups at 225mm centres until all bricks are installed.

Ensure that type M12 (or equivalent) mortar is used. Once mortar has achieved design strength, temporary support is removed and brickwork pointed. A full installation guide is available to download from www.ancon.co.uk.



Leviat[®]
A CRH COMPANY

Innovative engineered products and construction solutions that allow the industry to build safer, stronger and faster.



Worldwide contacts for Leviat:

Australia

Leviat
98 Kurrajong Avenue,
Mount Druitt Sydney, NSW 2770
Tel: +61 - 2 8808 3100
Email: info.au@leviat.com

Austria

Leviat
Leonard-Bernstein-Str. 10
Saturn Tower, 1220 Wien
Tel: +43 - 1 - 259 6770
Email: info.at@leviat.com

Belgium

Leviat
Industrielaan 2
1740 Ternat
Tel: +32 - 2 - 582 29 45
Email: info.be@leviat.com

China

Leviat
Room 601 Tower D, Vantone Centre
No. A6 Chao Yang Men Wai Street
Chaoyang District
Beijing · P.R. China 100020
Tel: +86 - 10 5907 3200
Email: info.cn@leviat.com

Czech Republic

Leviat
Business Center Šafránková
Šafránková 1238/1
155 00 Praha 5
Tel: +420 - 311 - 690 060
Email: info.cz@leviat.com

Finland

Leviat
Vädursgatan 5
412 50 Göteborg / Sweden
Tel: +358 (0)10 6338781
Email: info.fi@leviat.com

France

Leviat
6, Rue de Cabanis
FR 31240 L'Union
Toulouse
Tel: +33 - 5 - 34 25 54 82
Email: info.fr@leviat.com

Germany

Leviat
Liebigstrasse 14
40764 Langenfeld
Tel: +49 - 2173 - 970 - 0
Email: info.de@leviat.com

India

Leviat
309, 3rd Floor, Orion Business Park
Ghodbunder Road, Kapurbawdi,
Thane West, Thane,
Maharashtra 400607
Tel: +91 - 22 2589 2032
Email: info.in@leviat.com

Italy

Leviat
Via F.lli Bronzetti 28
24124 Bergamo
Tel: +39 - 035 - 0760711
Email: info.it@leviat.com

Malaysia

Leviat
28 Jalan Anggerik Mokara 31/59
Kota Kemuning, 40460 Shah Alam
Selangor
Tel: +603 - 5122 4182
Email: info.my@leviat.com

Netherlands

Leviat
Oostermaat 3
7623 CS Borne
Tel: +31 - 74 - 267 14 49
Email: info.nl@leviat.com

New Zealand

Leviat
2/19 Nuttall Drive, Hillsborough,
Christchurch 8022
Tel: +64 - 3 376 5205
Email: info.nz@leviat.com

Norway

Leviat
Vestre Svanholmen 5
4313 Sandnes
Tel: +47 - 51 82 34 00
Email: info.no@leviat.com

Philippines

Leviat
2933 Regus, Joy Nostalg,
ADB Avenue
Ortigas Center
Pasig City
Tel: +63 - 2 7957 6381
Email: info.ph@leviat.com

Poland

Leviat
Ul. Obornicka 287
60-691 Poznań
Tel: +48 - 61 - 622 14 14
Email: info.pl@leviat.com

Singapore

Leviat
14 Benoi Crescent
Singapore 629977
Tel: +65 - 6266 6802
Email: info.sg@leviat.com

Spain

Leviat
Polígono Industrial Santa Ana
c/ Ignacio Zuloaga, 20
28522 Rivas-Vaciamadrid
Tel: +34 - 91 632 18 40
Email: info.es@leviat.com

Sweden

Leviat
Vädursgatan 5
412 50 Göteborg
Tel: +46 - 31 - 98 58 00
Email: info.se@leviat.com

Switzerland

Leviat
Grenzstrasse 24
3250 Lyss
Tel: +41 - 31 750 3030
Email: info.ch@leviat.com

United Arab Emirates

Leviat
RA08 TB02, PO Box 17225
JAFZA, Jebel Ali, Dubai
Tel: +971 (0)4 883 4346
Email: info.ae@leviat.com

United Kingdom

Leviat
President Way, President Park,
Sheffield, S4 7UR
Tel: +44 - 114 275 5224
Email: info.uk@leviat.com

United States of America

Leviat
6467 S Falkenburg Rd.
Riverview, FL 33578
Tel: (800) 423-9140
Email: info.us@leviat.us

For countries not listed

Email: info@leviat.com

Leviat.com

Notes regarding this catalogue

© Protected by copyright. The construction applications and details provided in this publication are indicative only. In every case, project working details should be entrusted to appropriately qualified and experienced persons. Whilst every care has been exercised in the preparation of this publication to ensure that any advice, recommendations or information is accurate, no liability or responsibility of any kind is accepted by Leviat for inaccuracies or printing errors. Technical and design changes are reserved. With a policy of continuous product development, Leviat reserves the right to modify product design and specification at any time.



For more information on these products, contact:

Leviat

President Way
President Park
Sheffield, S4 7UR
United Kingdom

Tel: +44 (0) 114 275 5224

Fax: +44 (0) 114 276 8543

Email: info.ancon.uk@leviat.com

For sales enquiries:

Email: sales.ancon.uk@leviat.com

For technical enquiries:

Email: tech.ancon.uk@leviat.com

www.ancon.co.uk

www.leviat.com